

DCTC Sensory Room

OBJECTIVE

To create a calming study space for individuals who are sensitive to sensory input.

WHAT WE HEARD:

- A study space, not a resting space
- Include noise dampening solutions
- Include color that is calm, not distracting
- Include lighting that can cater to each student
- Include tools that calm the body (fidgets, etc.)

A NOTE ON COLOR:

[Pink] is associated with feelings of nurturing and love, and when lighter shades are used, can be quite soothing...

COLOR PALETTE

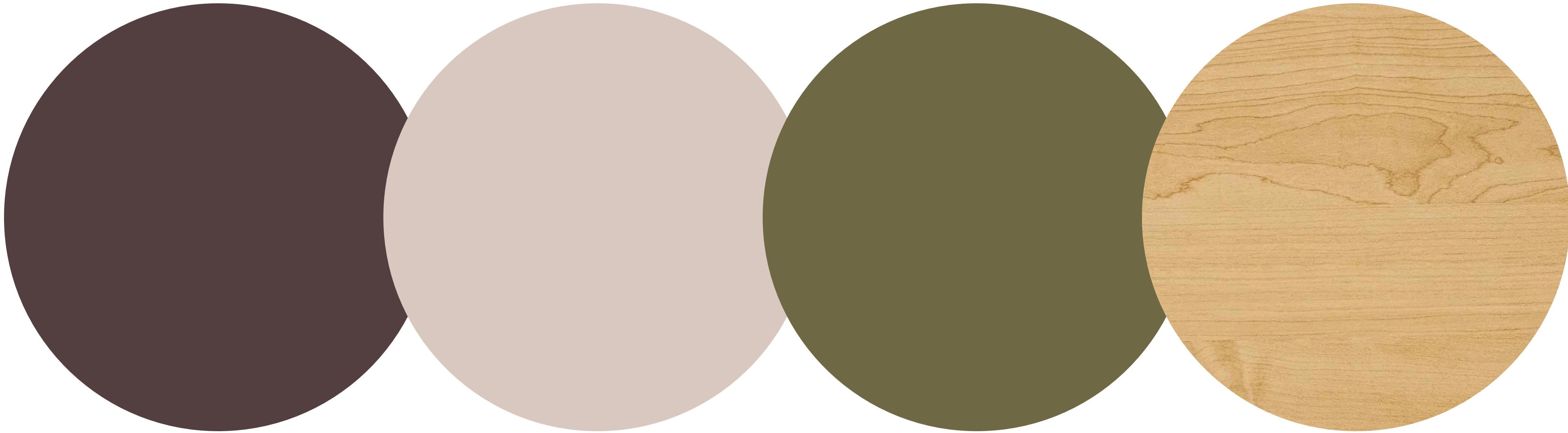

MATERIAL SELECTIONS

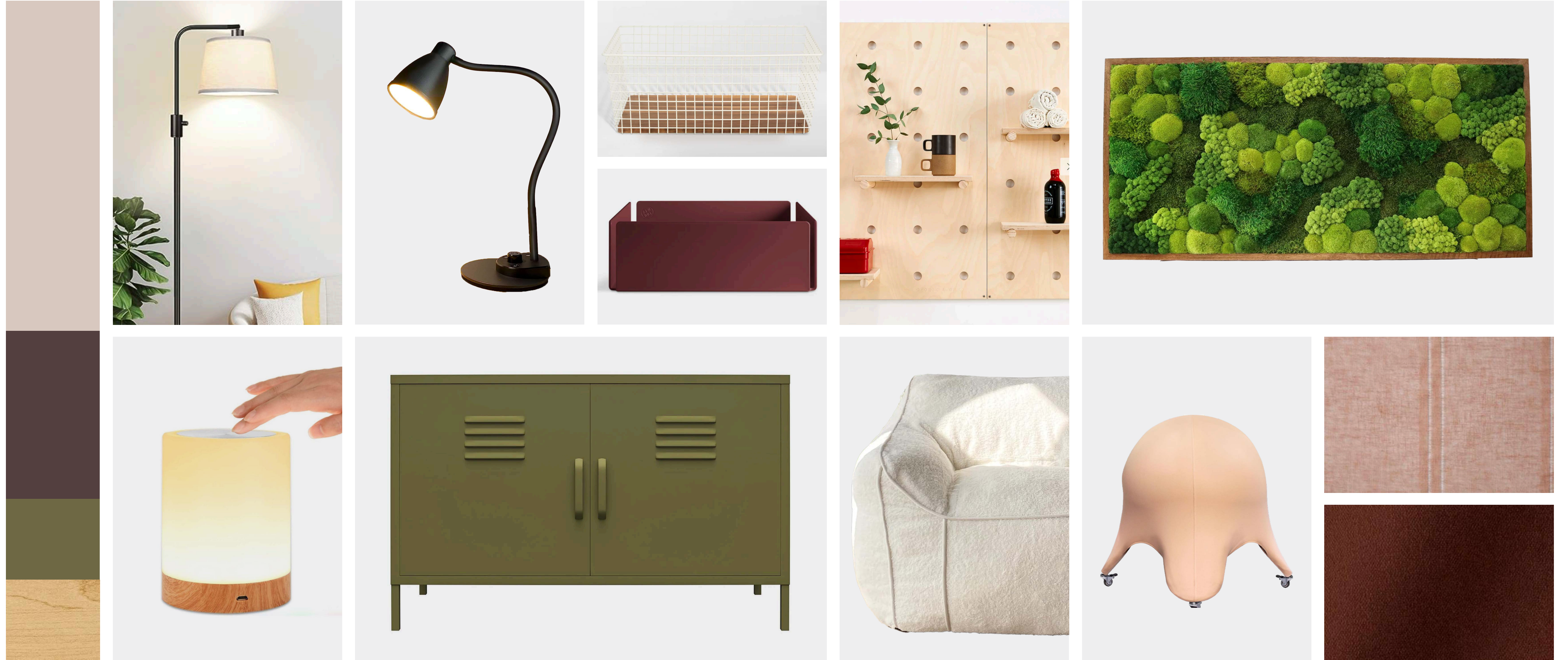

SENSORY SELECTIONS



IDES 1207



4/30/2024



PG. 7

FURNITURE PLAN

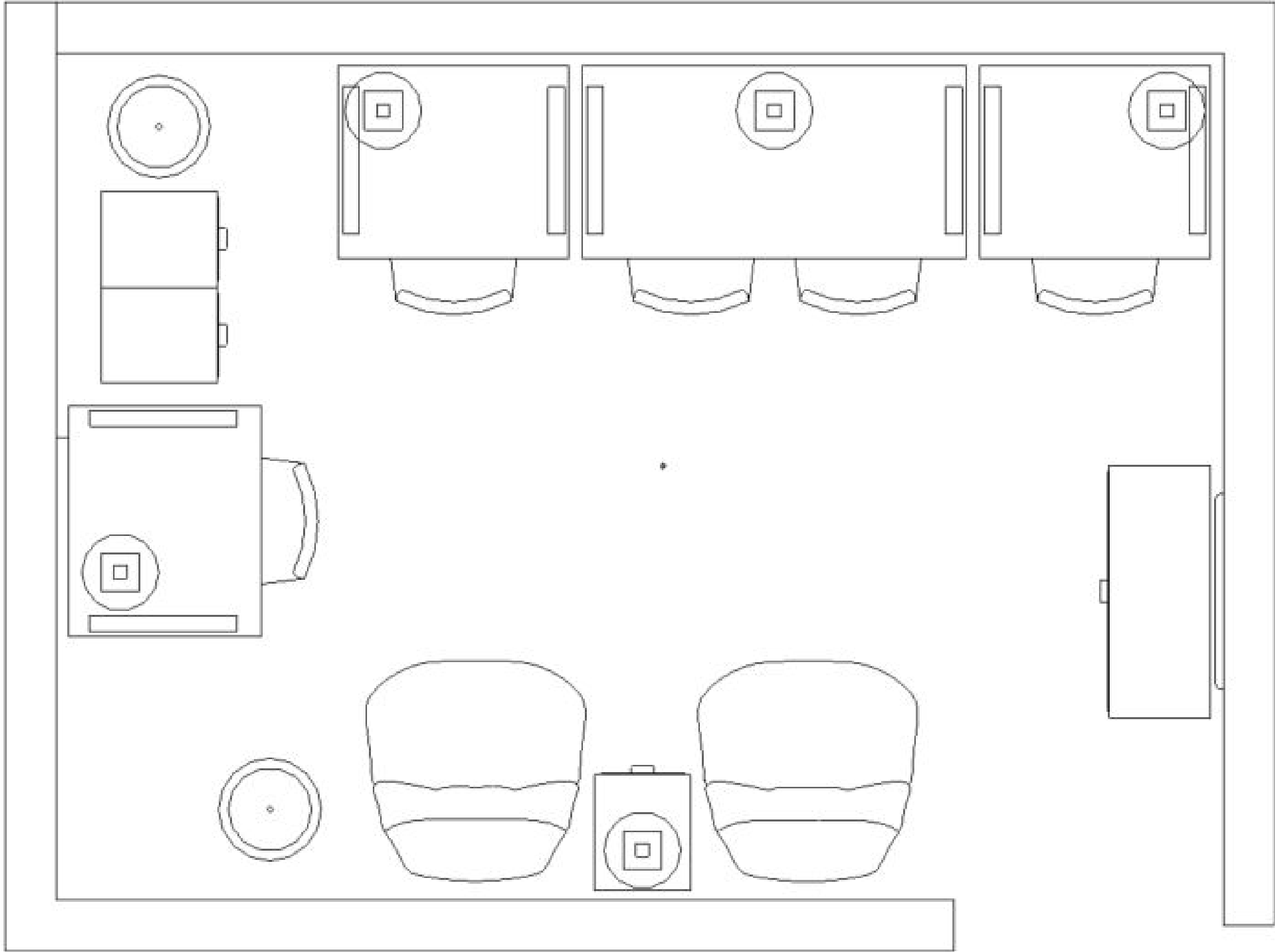

FURNITURE PLAN CONT.

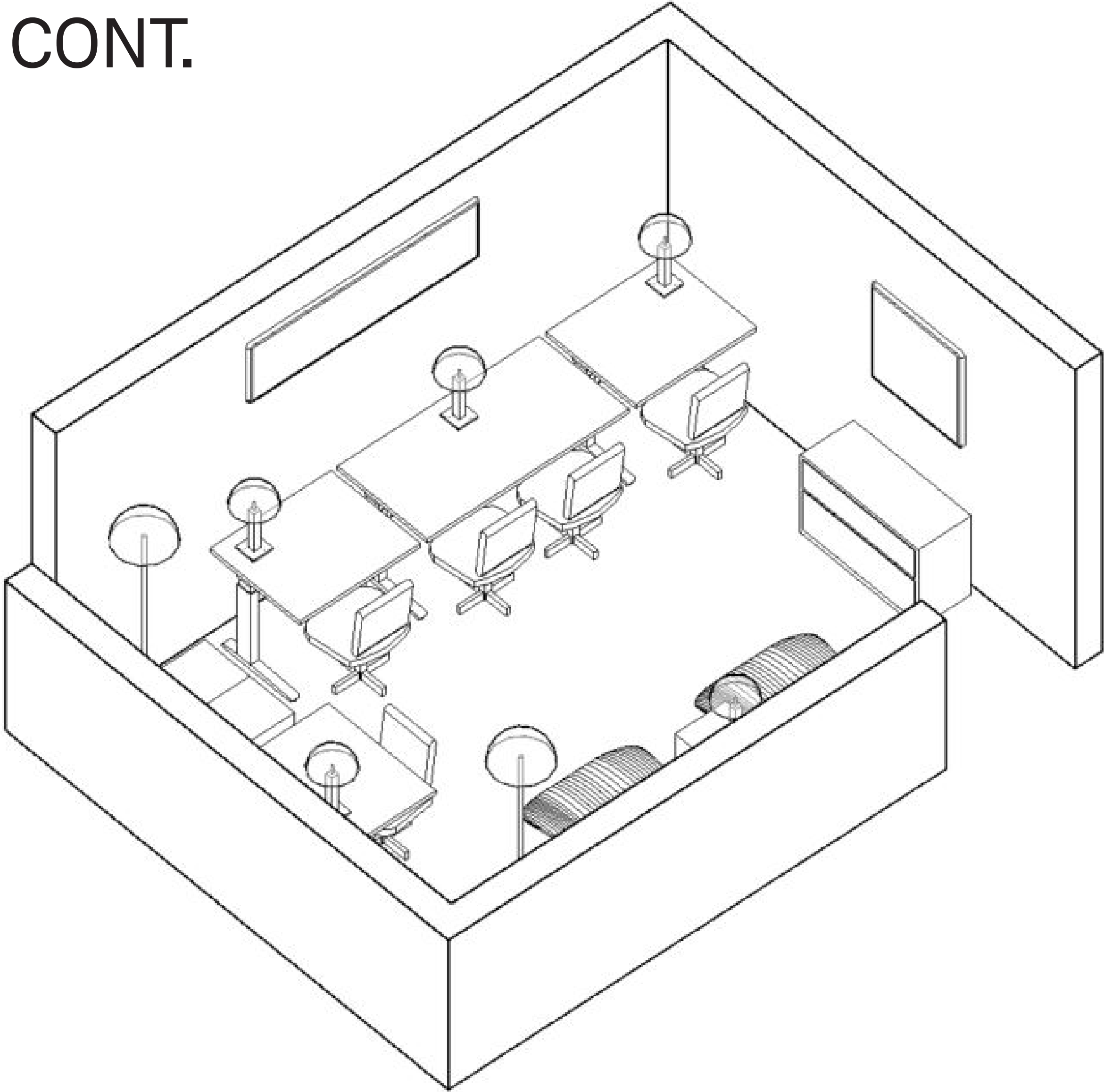

ELEVATION / MOSS WALL

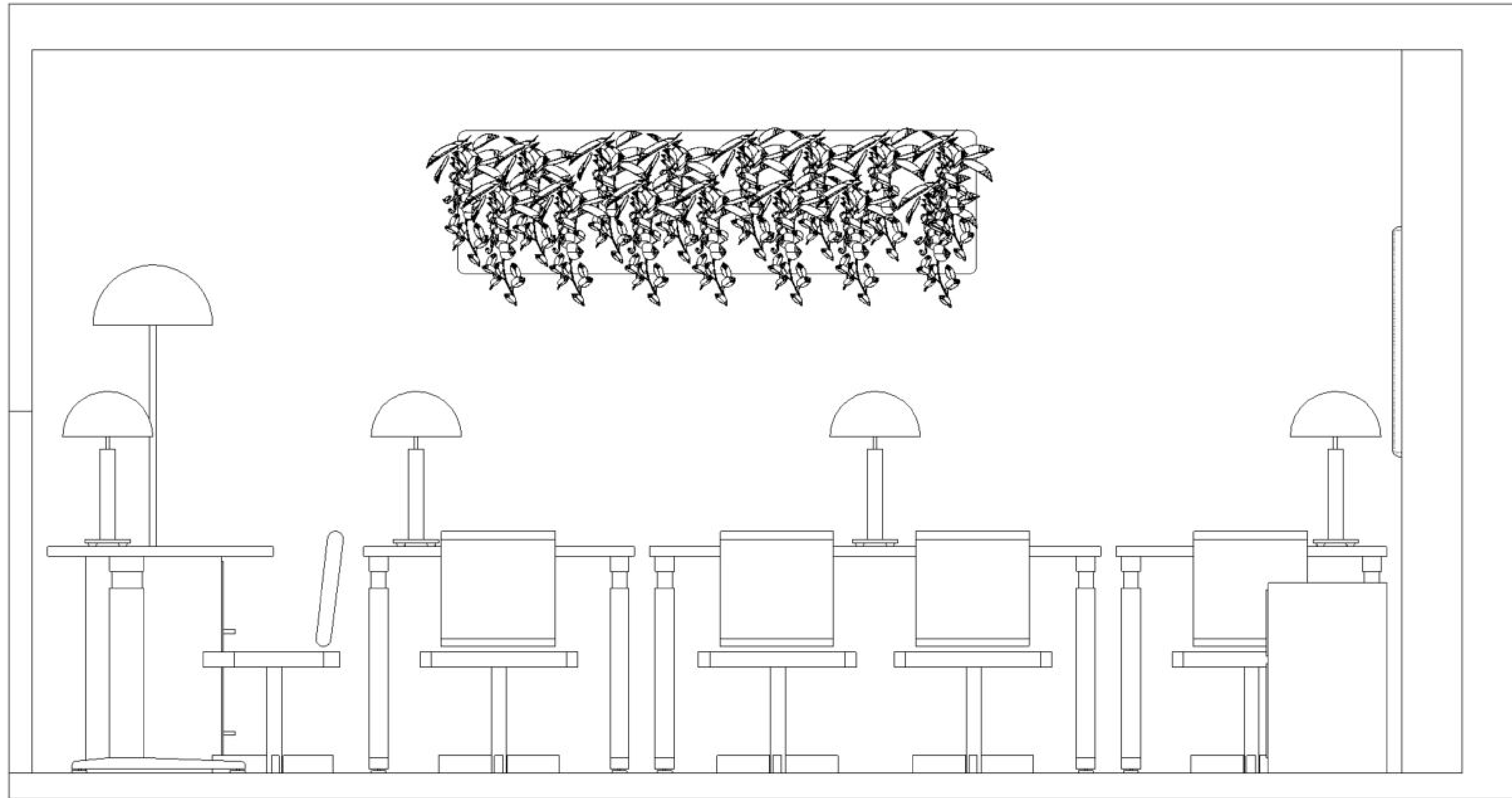

THANKS FROM YOUR DESIGNERS:

Angela, Ashley R., Britta,
Emily, Helen, Megan